

SPECIFICATION

Contact Rating	5A at 125V AC/3A at 250V AC 3A at 30V DC/0.1A at 30V DC	MS2-5
	6A at 125V AC/3A at 250V AC	MS2-6
	10.1A at 125V AC/250V AC	MS2-10
Mechanical Durability	10,000,000 cycles min	
Electrical Durability	100,000 cycles min	MS2-5
	10,000 cycles min	MS2-6 MS2-10
Contact Resistance	50mΩ (initial value)	
Insulation Resistance	100MΩ	
Dielectric Strength	Between terminals of the same polarity "AC 1000V 1min"	
	Between current-carrying metal parts and ground "AC 1500V 1min" Between each terminal and non-current-carrying metal part "AC 1500V 1min"	
Vibration Resistance	10~55Hz, 1.5mm double amplitude (for pin plunger)	
Shock Resistance	300m/s ² (for pin plunger)	
Operating Speed	0.1~1m/s (without load)	
Operating Frequency	300 operations/min (without load)	
Operating Temp.	-40°C ~ +105°C	MS2-5
	-25°C ~ +75°C	MS2-6 MS2-10

FEATURES

- ※Subminiature switch conforming to UL.
- ※PCB terminal and Solder terminal both available.
- ※Particular items withstand high voltage 2000 VAC / 1min.

APPLICATION

- ※Home appliances
- ※Vacuum cleaner
- ※Printers
- ※IC locks and low-voltage electrical equipments.

HOW TO ORDER

MS2 -

Rating:
01:0.1A at 30V DC
5:5A at 125V AC, 3A at 250V AC,
3A at 30V DC
6:6A at 125V AC, 3A at 250V AC
10:10.1A at 125V AC/250V AC

Actuator:
P:Pin plunger
L1:Hinge lever
L2:R type hinge lever
L3:Wheel type hinge lever
L4:Simulated roller lever
L12:18°upward bending lever
L13:32°upward bending roller lever

Operating Force(Max)
N:1.47N
F:0.74N

Plating:
(Au):Gold plating
(Ag):Silver plating

Terminal:
A:Solder terminal
D:PCB terminal
T:Quick-connect terminals

Contact Form:
-1:1c (SPDT)
-2:1b (SPST-NC)
-3:1a (SPST-NO)

CIRCUIT

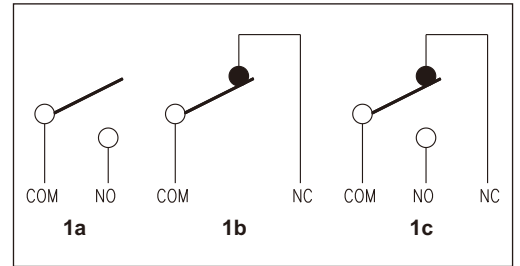

TYPE

Actuator	Terminal Type	Silver Alloy Contact	Silver Alloy Contact (Gold)	Silver Alloy Contact	
Pin Plunger	Solder Terminal	MS2-5PN-1A(Ag)	MS2-5PN-1A(Au)	MS2-6PN-1A(Ag)	MS2-10PN-1A(Ag)
		MS2-5PN-2A(Ag)	MS2-5PN-2A(Au)	MS2-6PN-2A(Ag)	MS2-10PN-2A(Ag)
		MS2-5PN-3A(Ag)	MS2-5PN-3A(Au)	MS2-6PN-3A(Ag)	MS2-10PN-3A(Ag)
	PCB Terminal	MS2-5PN-1D(Ag)	MS2-5PN-1D(Au)	MS2-6PN-1D(Ag)	MS2-10PN-1D(Ag)
		MS2-5PN-2D(Ag)	MS2-5PN-2D(Au)	MS2-6PN-2D(Ag)	MS2-10PN-2D(Ag)
		MS2-5PN-3D(Ag)	MS2-5PN-3D(Au)	MS2-6PN-3D(Ag)	MS2-10PN-3D(Ag)
	Quick Connect Terminal	-	-	MS2-6PN-1T(Ag)	MS2-10PN-1T(Ag)
		-	-	MS2-6PN-2T(Ag)	MS2-10PN-2T(Ag)
		-	-	MS2-6PN-3T(Ag)	MS2-10PN-3T(Ag)
Hinge Lever	Solder Terminal	MS2-5L1N-1A(Ag)	MS2-5L1N-1A(Au)	MS2-6L1N-1A(Ag)	MS2-10L1N-1A(Ag)
		MS2-5L1N-2A(Ag)	MS2-5L1N-2A(Au)	MS2-6L1N-2A(Ag)	MS2-10L1N-2A(Ag)
		MS2-5L1N-3A(Ag)	MS2-5L1N-3A(Au)	MS2-6L1N-3A(Ag)	MS2-10L1N-3A(Ag)
	PCB Terminal	MS2-5L1N-1D(Ag)	MS2-5L1N-1D(Au)	MS2-6L1N-1D(Ag)	MS2-10L1N-1D(Ag)
		MS2-5L1N-2D(Ag)	MS2-5L1N-2D(Au)	MS2-6L1N-2D(Ag)	MS2-10L1N-2D(Ag)
		MS2-5L1N-3D(Ag)	MS2-5L1N-3D(Au)	MS2-6L1N-3D(Ag)	MS2-10L1N-3D(Ag)
	Quick Connect Terminal	-	-	MS2-6L1N-1T(Ag)	MS2-10L1N-1T(Ag)
		-	-	MS2-6L1N-2T(Ag)	MS2-10L1N-2T(Ag)
		-	-	MS2-6L1N-3T(Ag)	MS2-10L1N-3T(Ag)

TYPE

Actuator	Terminal Type	Silver Alloy Contact	Silver Alloy Contact (Gold)	Silver Alloy Contact	
Simulated Roller Lever (small R)	Solder Terminal	MS2-5L2N-1A(Ag)	MS2-5L2N-1A(Au)	MS2-6L2N-1A(Ag)	MS2-10L2N-1A(Ag)
		MS2-5L2N-2A(Ag)	MS2-5L2N-2A(Au)	MS2-6L2N-2A(Ag)	MS2-10L2N-2A(Ag)
		MS2-5L2N-3A(Ag)	MS2-5L2N-3A(Au)	MS2-6L2N-3A(Ag)	MS2-10L2N-3A(Ag)
	PCB Terminal	MS2-5L2N-1D(Ag)	MS2-5L2N-1D(Au)	MS2-6L2N-1D(Ag)	MS2-10L2N-1D(Ag)
		MS2-5L2N-2D(Ag)	MS2-5L2N-2D(Au)	MS2-6L2N-2D(Ag)	MS2-10L2N-2D(Ag)
		MS2-5L2N-3D(Ag)	MS2-5L2N-3D(Au)	MS2-6L2N-3D(Ag)	MS2-10L2N-3D(Ag)
	Quick Connect Terminal	-	-	MS2-6L2N-1T(Ag)	MS2-10L2N-1T(Ag)
		-	-	MS2-6L2N-2T(Ag)	MS2-10L2N-2T(Ag)
		-	-	MS2-6L2N-3T(Ag)	MS2-10L2N-3T(Ag)
Hinge Roller Lever	Solder Terminal	MS2-5L3N-1A(Ag)	MS2-5L3N-1A(Au)	MS2-6L3N-1A(Ag)	MS2-10L3N-1A(Ag)
		MS2-5L3N-2A(Ag)	MS2-5L3N-2A(Au)	MS2-6L3N-2A(Ag)	MS2-10L3N-2A(Ag)
		MS2-5L3N-3A(Ag)	MS2-5L3N-3A(Au)	MS2-6L3N-3A(Ag)	MS2-10L3N-3A(Ag)
	PCB Terminal	MS2-5L3N-1D(Ag)	MS2-5L3N-1D(Au)	MS2-6L3N-1D(Ag)	MS2-10L3N-1D(Ag)
		MS2-5L3N-2D(Ag)	MS2-5L3N-2D(Au)	MS2-6L3N-2D(Ag)	MS2-10L3N-2D(Ag)
		MS2-5L3N-3D(Ag)	MS2-5L3N-3D(Au)	MS2-6L3N-3D(Ag)	MS2-10L3N-3D(Ag)
	Quick Connect Terminal	-	-	MS2-6L3N-1T(Ag)	MS2-10L3N-1T(Ag)
		-	-	MS2-6L3N-2T(Ag)	MS2-10L3N-2T(Ag)
		-	-	MS2-6L3N-3T(Ag)	MS2-10L3N-3T(Ag)
Simulated Roller Lever (Big R)	Solder Terminal	-	-	MS2-6L4N-1A(Ag)	MS2-10L4N-1A(Ag)
		-	-	MS2-6L4N-2A(Ag)	MS2-10L4N-2A(Ag)
		-	-	MS2-6L4N-3A(Ag)	MS2-10L4N-3A(Ag)
	PCB Terminal	-	-	MS2-6L4N-1D(Ag)	MS2-10L4N-1D(Ag)
		-	-	MS2-6L4N-2D(Ag)	MS2-10L4N-2D(Ag)
		-	-	MS2-6L4N-3D(Ag)	MS2-10L4N-3D(Ag)
	Quick Connect Terminal	-	-	MS2-6L4N-1T(Ag)	MS2-10L4N-1T(Ag)
		-	-	MS2-6L4N-2T(Ag)	MS2-10L4N-2T(Ag)
		-	-	MS2-6L4N-3T(Ag)	MS2-10L4N-3T(Ag)
18°upward Bending Lever	Solder Terminal	MS2-5L12N-1A(Ag)	MS2-5L12N-1A(Au)	MS2-6L12N-1A(Ag)	MS2-10L12N-1A(Au)
		MS2-5L12N-2A(Ag)	MS2-5L12N-2A(Au)	MS2-6L12N-2A(Ag)	MS2-10L12N-2A(Au)
		MS2-5L12N-3A(Ag)	MS2-5L12N-3A(Au)	MS2-6L12N-3A(Ag)	MS2-10L12N-3A(Au)
	PCB Terminal	MS2-5L12N-1D(Ag)	MS2-5L12N-1D(Au)	MS2-6L12N-1D(Ag)	MS2-10L12N-1D(Au)
		MS2-5L12N-2D(Ag)	MS2-5L12N-2D(Au)	MS2-6L12N-2D(Ag)	MS2-10L12N-2D(Au)
		MS2-5L12N-3D(Ag)	MS2-5L12N-3D(Au)	MS2-6L12N-3D(Ag)	MS2-10L12N-3D(Au)
	Quick Connect Terminal	-	-	MS2-6L12N-1T(Ag)	MS2-10L12N-1T(Au)
		-	-	MS2-6L12N-2T(Ag)	MS2-10L12N-2T(Au)
		-	-	MS2-6L12N-3T(Ag)	MS2-10L12N-3T(Au)
32°upward Bending Roller Lever	Solder Terminal	MS2-5L13N-1A(Ag)	MS2-5L13N-1A(Au)	MS2-6L13N-1A(Ag)	MS2-10L13N-1A(Au)
		MS2-5L13N-2A(Ag)	MS2-5L13N-2A(Au)	MS2-6L13N-2A(Ag)	MS2-10L13N-2A(Au)
		MS2-5L13N-3A(Ag)	MS2-5L13N-3A(Au)	MS2-6L13N-3A(Ag)	MS2-10L13N-3A(Au)
	PCB Terminal	MS2-5L13N-1D(Ag)	MS2-5L13N-1D(Au)	MS2-6L13N-1D(Ag)	MS2-10L13N-1D(Au)
		MS2-5L13N-2D(Ag)	MS2-5L13N-2D(Au)	MS2-6L13N-2D(Ag)	MS2-10L13N-2D(Au)
		MS2-5L13N-3D(Ag)	MS2-5L13N-3D(Au)	MS2-6L13N-3D(Ag)	MS2-10L13N-3D(Au)
	Quick Connect Terminal	-	-	MS2-6L13N-1T(Ag)	MS2-10L13N-1T(Au)
		-	-	MS2-6L13N-2T(Ag)	MS2-10L13N-2T(Au)
		-	-	MS2-6L13N-3T(Ag)	MS2-10L13N-3T(Au)

MICRO SWITCH MS2 SERIES



MICRO SWITCH

MS2-□P□-□A

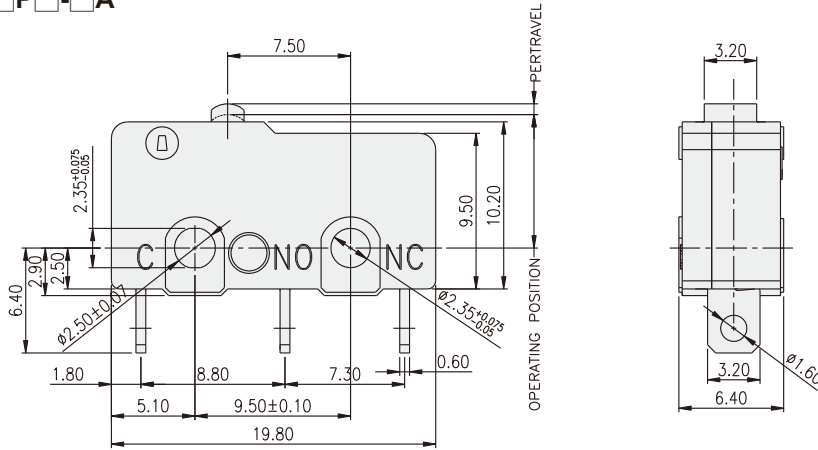

OPERATING CHARACTERISTICS

ITEM	SPEC.
OPERATING FORCE	1.47N MAX.
RELEASE FORCE	0.25N MIN.
OVERTRAVEL	0.50mm MIN.
MOVEMENT DIFFERENTIAL	0.10mm MAX.
OPERATING POSITION	8.40±0.50mm
FREE POSITION	-
PRE TRAVEL	0.50mm MAX.

MS2-□L1□-□A

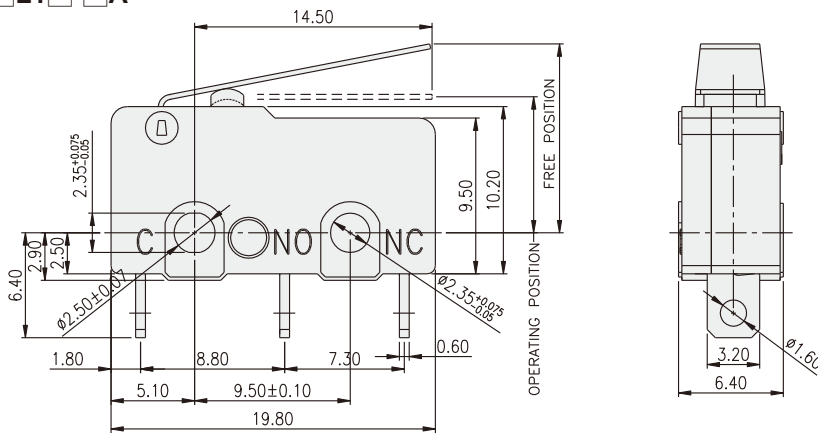

OPERATING CHARACTERISTICS

ITEM	SPEC.
OPERATING FORCE	0.49N MAX.
RELEASE FORCE	0.06N MIN.
OVERTRAVEL	1.20mm MIN.
MOVEMENT DIFFERENTIAL	0.80mm MAX.
OPERATING POSITION	8.80±0.80mm MS2-6 8.90±0.80mm
FREE POSITION	12.0mm MAX.
PRE TRAVEL	-

MS2-□L2□-□A

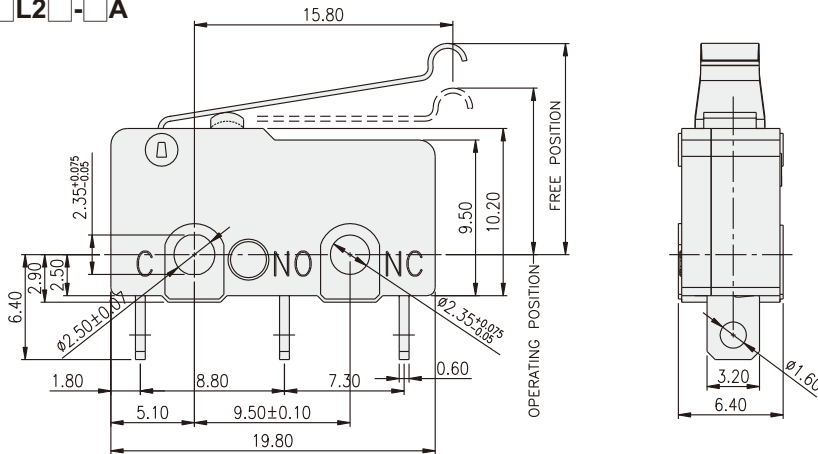

OPERATING CHARACTERISTICS

ITEM	SPEC.
OPERATING FORCE	0.49N MAX.
RELEASE FORCE	0.06N MIN.
OVERTRAVEL	1.20mm MIN.
MOVEMENT DIFFERENTIAL	0.80mm MAX.
OPERATING POSITION	10.70±0.80mm
FREE POSITION	15.50mm MAX.
PRE TRAVEL	-

MS2-□L3□-□A

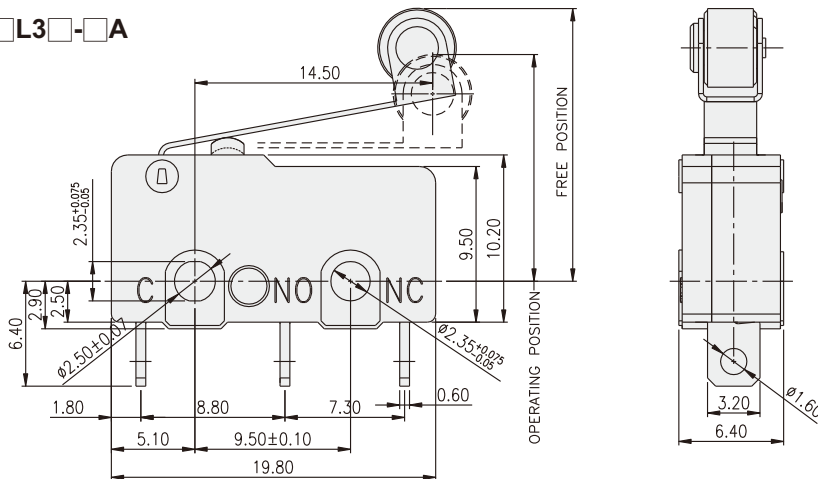

OPERATING CHARACTERISTICS

ITEM	SPEC.
OPERATING FORCE	0.49N MAX.
RELEASE FORCE	0.06N MIN.
OVERTRAVEL	1.20mm MIN.
MOVEMENT DIFFERENTIAL	0.80mm MAX.
OPERATING POSITION	14.50±0.80mm
FREE POSITION	19.30mm MAX.
PRE TRAVEL	-

MS2-□L4□-□A

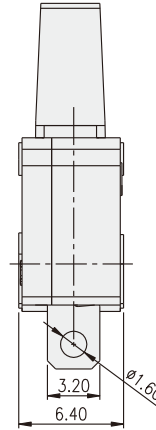
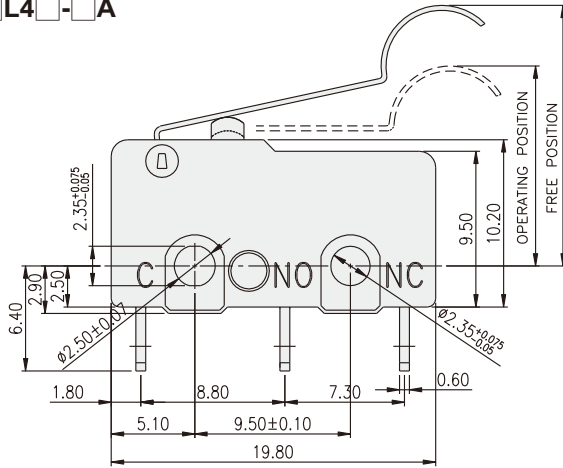

OPERATING CHARACTERISTICS

ITEM	SPEC.
OPERATING FORCE	0.49N MAX.
RELEASE FORCE	0.06N MIN.
OVERTRAVEL	1.20mm MIN.
MOVEMENT DIFFERENTIAL	0.80mm MAX.
OPERATING POSITION	15±0.80mm
FREE POSITION	19mm MAX.
PRE TRAVEL	-

MS2-□L12□-□A

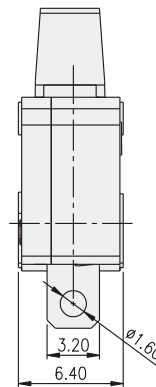
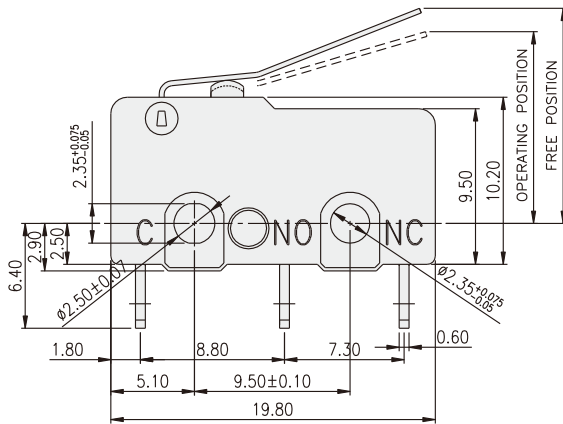

OPERATING CHARACTERISTICS

ITEM	SPEC.
OPERATING FORCE	0.49N MAX. MS2-5 0.50N MIN.
RELEASE FORCE	0.06N MIN.
OVERTRAVEL	1.20mm MIN.
MOVEMENT DIFFERENTIAL	0.80mm MAX.
OPERATING POSITION	12±0.80mm
FREE POSITION	16mm MAX.
PRE TRAVEL	-

MS2-□L13□-□A

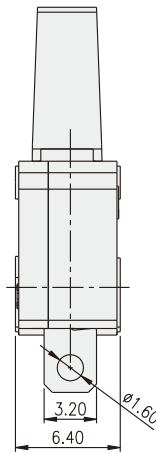
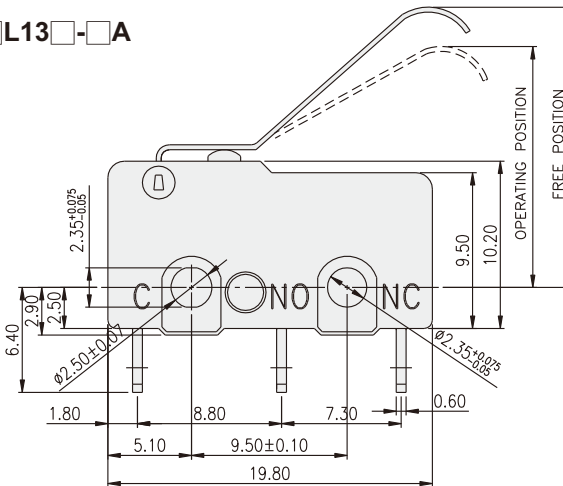

OPERATING CHARACTERISTICS

ITEM	SPEC.
OPERATING FORCE	0.49N MAX.
RELEASE FORCE	0.06N MIN.
OVERTRAVEL	1.20mm MIN.
MOVEMENT DIFFERENTIAL	0.80mm MAX.
OPERATING POSITION	15±0.80mm
FREE POSITION	19mm MAX.
PRE TRAVEL	-

TERMINAL TYPE

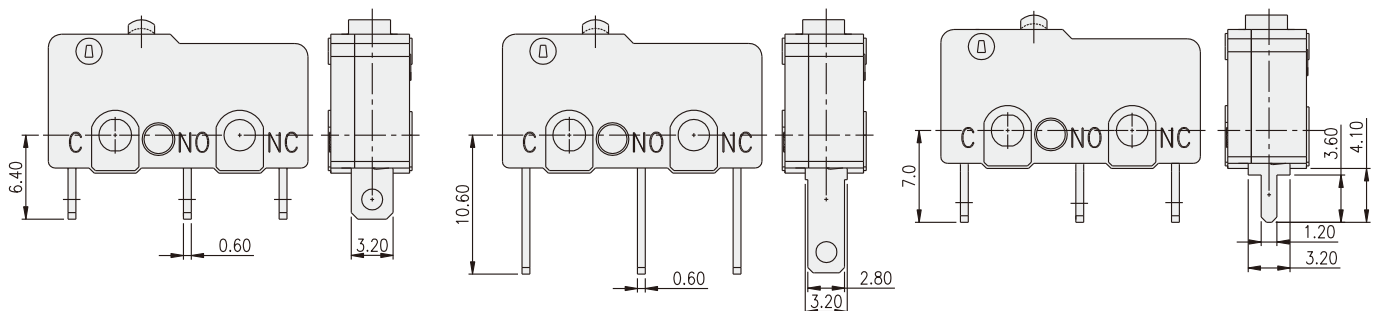

A(Solder terminal)

T(Quick-connect terminal)

D(PCB terminal)